



CYCLO MODEL 12A PNEUMATIC DUAL HEAD ORBITAL POLISHER INSTRUCTION MANUAL



CONTENTS

SAFETY INSTRUCTIONS	1
DETAILING BASICS	2
CYCLO POLISHER SET-UP	3
GUIDE TO GENUINE CYCLO ACCESSORIES	5
MACHINE OPERATING INSTRUCTIONS	8
USER MAINTENANCE & TROUBLESHOOTING	9
TECHNICAL SPECIFICATIONS.....	10
PARTS DIAGRAMS AND LISTING.....	11
APPLICATION AND ACCESSORIES QUICK GUIDE	11

This instruction manual is furnished with each Cyclo[®] Model 12A Pneumatic Dual Head Orbital Polisher. The entire manual should be read carefully before using the Cyclo Dual Head Orbital Polisher and retained for future reference. Employers are responsible for ensuring that employees are provided with a copy of these instructions and adequate training prior to operating the tool.

SAVE THESE INSTRUCTIONS

SAFETY INSTRUCTIONS

WARNING: Read and save all instructions. Failure to follow all instructions listed below may result in serious injury. Ensure that you operate and maintain this tool in accordance with the Compressed Air & Gas Institute - Safety Code for Portable Air Tools (CAGI B186.1) and any other applicable safety codes and regulations. CAGI B186.1 is available from CAGI • 1300 Sumner Avenue • Cleveland, Ohio 44115-2851 (www.cagi.org). The term "power tool" in all the warnings listed below refers to your Cyclo Toolmakers pneumatic power tool.

	⚠ WARNING Read and understand tool manual before work starts to reduce risk of injury to operator, visitors, and tool.		⚠ WARNING Practice safety requirements. Work alert, have proper attire, and do not operate tools under the influence of alcohol or drugs.
	⚠ WARNING Eye protection must be worn at all times. Eye protection to conform to ANSI Z87.1.		⚠ WARNING Ear protection to be worn when exposure to sound exceeds the limits of applicable federal, state, or local statutes ordinances and/or regulations.
	⚠ WARNING Respiratory protection to be used when exposed to contaminants that exceed the applicable threshold limit values required by law.		⚠ WARNING Air line hazard: pressurized supply lines and flexible hoses can cause serious injury. Do not use damaged, frayed or deteriorated hoses or fittings.

1) Work Area Safety

- Keep work area clean and well lit.** Cluttered and dark areas invite accidents.
- Do not operate power tools in explosive atmospheres, such as in the presence of flammable liquids, gasses or dust.** Power tools can create sparks which may ignite the dust or fumes.
- Keep children and bystanders at a safe distance while operating a power tool.** Distractions can cause you to lose control.

2) Pneumatic Tool Use & Safety

- Only use recommended fittings and air line sizes.** Ensure air supply hoses and air hose assemblies are rated with a minimum working pressure rating of 150 PSIG or 150% of the maximum pressure produced in the system, whichever is greater.
- Ensure that the tool's inlet pipe is secured with a pipe wrench prior to installing the air fitting.** Do not allow the pipe to turn as this may damage valve assembly.
- Do not expose tool to inlet pressure above 90 PSIG or 6.2 Bar/620 kPa.** Periodically check tool speed. Using a tachometer while the tool is in operation, set air pressure at tool inlet at 90 PSIG or 6.2 Bar/620 kPa. If the tool is operating at a speed more than 10% higher than the rated speed (RPM) marked on the tool housing, do not use the tool until it is repaired.
- The air supply should be free of moisture.** To remove moisture from the air supply, use a refrigerated air dryer after the compressor and use drain valves in air system.
- The drip rate of the of the air system lubricator should be set at one drop/minute per 20 SCFM flow rate through the lubricator.**
- Do not force the power tool.** Use the correct power tool for your application. The correct power tool will do the job better and safer at the rate for which it was designed.
- Do not use the power tool if the throttle lever does not turn it on and off.** Any power tool that cannot be controlled with the lever is dangerous and must be repaired.
- Disconnect the tool from the air supply before making any adjustments, changing accessories, or storing power tools.** Such preventive safety measures reduce the risk of starting the power tool accidentally.
- Store idle power tools out of the reach of children, and do not allow persons unfamiliar with the power tool or these instructions to operate the power tool.** Power tools are dangerous in the hands of untrained users.
- Use the power tool, accessories and tool bits etc. in accordance with these instructions and in the manner intended for the particular type of power tool, taking into account the working conditions and the work to be performed.** Use of the power tool for operations different from those intended could result in a hazardous situation.
- Use the power tool, accessories and tool bits etc. in accordance with these instructions and in the manner intended for the particular type of power tool, taking into account the working conditions and the work to be performed.** Use of the power tool for operations different from those intended could result in a hazardous situation.
- Do not abuse hose.** Do not force sharp bend in cord, especially where it exits the handle and particularly when curling hose for storage.
- Position the hose clear of the spinning accessory.** If you lose control, the air hose may be cut or snagged and your hand or arm may be pulled into the spinning accessory.
- Never lay the power tool down until the accessory has come to a complete stop.** The spinning accessory may grab the surface and pull the power tool out of your control.

3) Personal Safety

- a) **Stay alert, watch what you are doing and use common sense when operating a power tool.** Do not use a power tool while you are tired or under the influence of drugs, alcohol or medication. A moment of inattention while operating power tools may result in serious personal injury.
- b) **Use safety equipment. Always wear eye protection.** Safety equipment such as dust mask, non-skid safety shoes, hard hat, or hearing protection used for appropriate conditions will reduce personal injuries.
- c) **Avoid accidental starting. Ensure the throttle lever is not depressed before connecting to air supply.** Carrying power tools with your finger on the lever or connecting air-powered tools that have the lever depressed invites accidents.
- d) **Remove any adjusting key or wrench before turning the power tool on.** A wrench or key left attached to a rotating part of the power tool may result in personal injury.
- e) **Do not overreach. Keep proper footing and balance at all times.** This enables better control of the power tool in unexpected situations.
- f) **Dress properly. Do not wear loose clothing or jewelry. Keep your hair, clothing and gloves away from moving parts.** Loose clothes, jewelry or long hair can be caught in moving parts.
- g) **Ensure that you have provided proper support for the work piece.** For example, if polishing a part not attached to a vehicle, clamp it securely to a workbench. A loose workpiece may be propelled by the tool if not supported or fixed in place.
- h) **Be aware that wrist, hand, arm, or shoulder fatigue or injury may occur with prolonged exposure to vibration or motion.**
- i) **Do not run the power tool while carrying it at your side.** Accidental contact with the spinning accessory could snag your clothing, pulling the accessory into your body.

4) Maintenance & Service Instructions

- a) **Maintain Tool with Care. Keep the tool clean for better and safer performance.**
- b) **Follow instructions for lubricating and changing accessories. Inspect air hose periodically and replace if damaged. Keep handles dry, clean, and free from oil and grease.**
- c) **Using compressed air, blow dry the bearings under the heads or pads.** This should only be performed with the air supply disconnected from the tool and with proper eye protection.
- d) **Check for misalignment or binding of moving parts, breakage of parts and any other condition that may affect the power tool's operation.** If damaged, have the power tool repaired before use. A part that is damaged should be properly repaired or replaced by Cyclo Toolmakers or a Cyclo authorized service center. Many accidents are caused by poorly maintained power tools.
- e) **Always blow air supply hose out prior to using the tool.** This helps assure clean air for powering the tool.
- f) **Periodically inspect air hoses and fittings for damage or wear. Replace frayed, damaged, or worn out hoses or fittings.**
- g) **Keep air tool stampings and label on tool visible.**

5) Safety Warnings for Polishing Operations.

This power tool is intended to function as a polisher only. Do not use this tool for anything other than its intended application. Read all safety warnings, instructions, illustrations and specifications provided with this power tool. Employers are responsible for ensuring that employees are provided with a copy of these instructions and adequate training prior to operating the tool. Failure to follow all instructions may result in serious injury.

- a) **Operations such as sanding, grinding, wire brushing, or cutting off should not be performed with this power tool.** Operations for which the power tool was not designed may create a hazard and cause personal injury.
- b) **Do not use accessories which are not designed and recommended by the tool manufacturer.** Just because the accessory can be attached to your power tool, it does not assure safe operation.
- c) **The rated speed of the accessory must be at least equal to the maximum speed marked on the power tool.** Accessories running faster than their rated speed can break and fly apart.
- d) **The outside diameter and the thickness of your accessory must be within the capacity rating of your power tool.** Incorrectly sized accessories cannot be adequately guarded or controlled.
- e) **Do not use a damaged accessory.** Before each use inspect the accessory such as backing plate or pad for cracks, tear or excess wear.
- f) **If power tool or accessory is dropped, inspect for damage to install an undamaged accessory.** After inspecting and installing an accessory, position yourself and bystanders away from the plane of the rotating accessory and run the power tool at maximum no-load speed for one minute. Damaged accessories will normally break apart during this test time.
- g) **Wear personal protective equipment.** Depending on application, use a face shield, safety goggles or safety glasses. As appropriate, wear dust mask, hearing protectors, gloves and workshop apron capable of stopping small abrasive or work piece fragments. The eye protection must be capable of stopping flying debris generated by various operations. The dust mask or respirator must be capable of filtering particles generated by your operation. Prolonged exposure to high intensity noise may cause hearing loss.
- h) **Keep bystanders a safe distance away from work area.** Anyone entering the work area must wear personal protective equipment. Fragments of work piece or of a broken accessory may fly away and cause injury beyond immediate area of operation.
- i) **Do not allow any loose portion of the polishing bonnet or its attachment strings to spin freely.** Tuck away or trim any loose attachment strings. Loose and spinning attachment strings can entangle your fingers or snag on the workpiece.

DETAILING BASICS

This section presents the basic steps involved in vehicle detailing, much of which is accomplished without your Cyclo polisher. More instructions on polisher operation are provided later in this manual.

1) Washing

- a) **Soap.** To wash the vehicle and remove old wax or polish, use cold or warm water and a dishwashing detergent. A standard detergent usually requires 1-2 ounces per gallon of water. If you do not wish to remove existing wax, then use a car washing soap that has a neutral pH, making it "wax-friendly." This describes most "car wash" soap products.
- b) **Sponges, mitts and more.** It is important to use an appropriate washing device. This includes wash mitts and sponges made from foams, wool and other materials. Advancements in detailing tools include specific types of products designed for easy wheel cleaning, safe, yet aggressive bug removal, and a gentle wash while providing a comfortable fit. They need to be easy to use and assuredly not scratch the surface.
- c) **Application tips.** Use a mitt or sponge that holds the car wash solution. The more solution the mitt or sponge can hold, the more lubricating soapy water you can get onto the surface to be cleaned. Lubrication created by soapy water helps prevent dirt from scratching the surface while being cleaned. Start up high -- away from most of the grit and grime. Rinse your mitt or sponge out frequently. You do not want to

rub grit into the paint and cause swirls or scratches. Prepare two 5 gallon buckets by filling one half-full with the soap-and-water wash solution and the other bucket three-quarters full with clear rinse water.

- d) **Rinse before and after you wash.** Rinse the vehicle thoroughly, starting at the top and working your way down. Pre-rinsing is an important step and should not be skipped. Then wash the vehicle, then rinse again.
- e) **Do it in the shade.** Washing and most other detailing work should be performed out of direct sunlight. Avoid rapid evaporation which can create hard water spots. Do not allow chemicals to dry on painted surfaces or trim pieces.
- f) **Environment.** Make sure that you are practicing good environmental stewardship. Use appropriate cleaners on paints, wheels and metals. Follow all applicable guidelines for water containment. Utilize as little water as necessary and never leave a water hose running when not in use.

2) Claying

- a) **Clay bars and optional use.** Clay bars are used to remove paint over spray, tree sap, airborne contaminants and industrial fallout from the cars painted surfaces. Clay also works well on glass, plastics and many metals. Claying is an optional step performed before polishing. When hard paint contaminants are present, claying first then polishing can save time over polishing only.
- b) **Paint surface check.** Use a plastic sandwich bag or any type of thin plastic bag as a tool to inspect the painted surface. Using a clean plastic bag with your fingers or hand inside, run your finger tips across the painted surface. Be careful not to drag any loose debris. The plastic increases the sensitivity of your fingertips to contaminants. Your paint may feel clean and smooth to the bare hand's touch, but with a plastic bag over your hand, it is a different story! The bumps and roughness you may feel are contaminants and pollutants that need removed for a show car finish. After using detailing clay, the surface will be as smooth as glass and ready for polishing.
- c) **Application tips.** Thoroughly wash and dry the vehicle. Cut a large clay bar into smaller, more manageable pieces. Begin by spraying a clay bar lubricant over a 2' x 2' area. Hold the clay bar so that your hand and finger nails do not touch the painted surface. Glide the clay bar across the area. We recommend that you work in a consistent direction – not cross hatching. Move the clay bar back and forth, and you will begin to feel it cleaning the surface. When claying entire vehicles, it is best to begin at the top and then work your way to the lower areas. Inspect the clay bar often and remove large contaminants that could scratch. When the clay bar becomes dirty you can switch to the clean side or knead the clay to extend its use. Continue the process around the entire vehicle until all painted surfaces, glass, chrome, metal pieces and coated wheels have been clayed. Then the painted surface will be smooth and ready for polishing and waxing.
- d) **Special tips and guidelines.** You can save time by using the clay bar after the final wash rinse, while the surface is still wet. Never allow a clay bar to drop on the ground. It would be nearly certain to pick up a scratching hazard; if so contaminated, it should be discarded. It is important that you work on the vehicle in a shaded area, away from direct sunlight.
- e) **Re-rinse.** Re-rinse or re-wash the vehicle if necessary to clean up after claying.

3) Drying

- a) **Dry thoroughly.** The vehicle should be completely dry before polishing and waxing. Scratches can easily be imparted when substandard towels are used for drying. Discarded household towels should never be used to dry a vehicle. They can scratch the surface and produce lint. There are several professional quality tools including microfiber towels, drying air blowers, water blades, chamois and available to reduce drying time.

4) What Is Polishing - It Is Important That You Do Not Just Wax

- a) **Your paint's appearance is dependent on being well polished to a highly reflective, smooth finish.** Polishing removes oxidation, old wax buildup and other contaminants while cleaning, leveling and shining your paint. Polishing can smooth the edges of larger imperfections and even remove light scratches. Polishing is important to prepare the surface for protecting with a sealant or wax.
- b) **It is important to remove all of the oxidation, wax buildup and contaminants before applying a wax or sealant.** You do not want to seal in the contaminants.



Profile image of paint with scratches in and oxidation and pollutants on the clear coat.

5) Swirls, Scratches and Other Defects Removal

- a) **Swirls and holograms are imperfections in paint appearance caused by thousands of microscopic scratches in the clear coat.** These scratches can be the result of polishing with a high speed buffer, dirt and sand in the air, rough drying towels and car wash and snow removal brushes. The removal of swirls and holograms is accomplished by removing the fine scratches. Your Cyclo polisher does this with the right combination of liquid compounds, polishes and pads and the correct technique.
- b) **If a scratch catches your fingernail then it's likely too deep to remove.** Polishing the scratched area is still recommended. However, do so with the idea that you are attempting to make the defect less noticeable but not to remove it entirely. Some scratches and swirl marks are too deep to safely remove. Attempting to do so may result in buffing through the top layer of paint or clear coat and permanent damage. Always test in an inconspicuous area.
- c) **Severe scratch and defect removal requires advanced training and the correct combination of detailing liquid compounds and polishes, pad selection and high speed rotary buffer application.** We do not recommend cutting or compounding paint with a high speed rotary buffer without prior experience.



Profile image of paint with various scratches.

CYCLO POLISHER SET-UP

1) Determine the Intended Application and Appropriate Attachment System Configuration for Your Application

- a) **Polishing/Waxing/Buffering/Deoxidation/Cutting/Compounding/Swirl Removal**
 - Automotive paints and gel coats on cars, buses, boats, RVs, aircraft, and more.
 - ProGuard™ Orbital Backing Plates, heads with Rubber Pad Holders, or DoublePrecision™ adapters for 2-sided pads
- b) **Metal Polishing**
 - Aluminum, stainless steel and chrome.
 - ProGuard Orbital Backing Plates, heads with Rubber Pad Holders, or DoublePrecision adapters
- c) **Scrubbing Carpets/Upholstery/Fabrics**
 - Interior and exterior applications.
 - Scrub brushes, ProGuard Orbital Backing Plates with foam pads and pad covers, heads with Rubber Pad Holders with foam pads and pad covers, DoublePrecision 2-sided pads with pad covers

d) **Other Miscellaneous Applications.**

- Hockey arena boards: FastCut™ Discs on ProGuard Orbital Backing Plates or on heads with Rubber Pad Holders
- Tile and grout cleaning: Scrub brushes
- Headlight restoration: ProShine™ Discs and Interface pads on ProGuard Orbital Backing Plates, heads with Rubber Pad Holders or DoublePrecision 2-sided pads (uses DoublePrecision Interface pad).

e) **Refer to the application chart (on the back cover) for additional information and product application suggestions.**

2) **Backing Plates and Attachment Alternatives**

a) **ProGuard Orbital Backing Plates (79-112-5/16)**

- Featuring a low profile for improved control and a non-marking bumper for safe operation. The advanced design ensures against de-lamination with the plate-integrated hook field, provides faster pad centering and is perfect for quick and easy pad changes. For use with 72- series foam and wool pads.

b) **Rubber Pad Holders (79-101)**

- Durable, long-lasting Pad Holders fit directly over the Cyclo Polisher Head Assemblies to hold 72- Series pads via Velcro hook face.

c) **Head Assemblies (60-055)**

- The original backing plate for Rubber Pad Holders or foam and wool bonnets (71- series foam and wool pads permanently attached to a rubber boot). Rubber Pad Holders fit directly over the Head Assemblies.

d) **Quick Connect Adapters (79-725-5/16)**

- Center pads easily and save time by simply snapping the pads in place. System replaces Cyclo Polisher heads to hold 77- Series Double-Precision, two-sided pads.

e) **Scrubbing Brushes (76-xxx)**

- Genuine Cyclo scrubbing brushes have integral connectors which screw directly into the Cyclo Polisher replacing the heads. By simply attaching two Cyclo Brushes you can clean carpet, upholstery, tile, grout and more.

f) **ProShine Interface Pad (72-920, 77-920)**

- Cushion backing plate for ProShine abrasive discs. Interface pads improve performance by allowing the sanding disc



3) **Configure the Vibration Elimination System (VES)™ Counterweights on Your Polisher.**

- a) When new, your polisher will have Cyclo Toolmakers' exclusive VES counterweight system but may have no VES weighted insert installed. You will need to install the appropriate weighted insert then install whichever attachment you will be using: ProGuard OBP, Rubber Pad Holders, Brushes, or DoublePrecision Adapters.
- b) With air supply hose not connected, lay the polisher upside-down on your lap, a bench or other flat surface.
- c) Determine the attachment system configuration that you intend to use (see section 1 above)
- d) Select the appropriate VES weighted insert from the table below.
- e) Thread the weighted insert into the counterweight and hand tighten using the 7/32" L-hex key (included).
- f) **IMPORTANT!** Tighten VES weighted insert firmly by attaching the 5/8" flat wrench (included) to the counterweight's threaded nut style fitting, and turn counterclockwise until you make contact with the L hex key. Use the flat wrench pivoting on hex wrench to prevent counterweight from turning while tightening the weighted insert. Turn the L hex key clockwise to tighten VES weighted insert firmly. Do not overtighten.

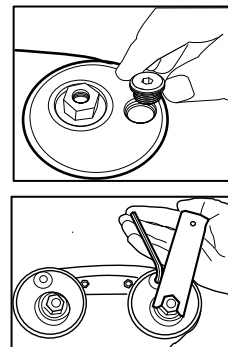



Attachment System:	ProGuard™ Orbital Backing Plates	Carpet And Scrub Brushes or DoublePrecision Adapters	Rubber Pad Holders or Bonnets over Head Assemblies
Description (part #):	6.5g Weight, Blue (20-072)	18.75g Weight, Silver, 1 Stripe	32g Weight, Yellow, 2 Stripes(20-078)
Weighted Insert (Top And Side Views)			

Table 1: Adjustable VES Counterweight Application Table

Why Low Vibration Is Important: Operators face significant risk of muscle, joint and nerve damage caused by the hand-arm vibration of many power tools. By reducing the amount of vibration you can reduce muscle and joint fatigue as well as the potential risk for permanent damage, as described in the ISO 5349-1:2001 standard, Mechanical vibration -- Measurement and evaluation of human exposure to hand-transmitted vibration. Cyclo Toolmakers' machines are designed to minimize vibration.

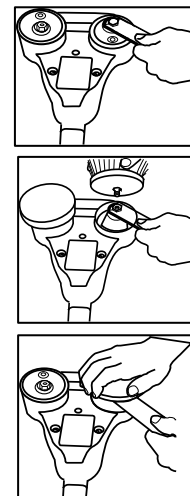

4) **Attaching Head Assemblies, Quick Connect Adapters, Scrub Brushes, ProGuard Orbital Backing Plates and other accessories.**

- a) Lay the polisher upside-down on your lap, a bench or flat surface. You may also use the cardboard insert removed from inside the polisher box to support polisher and hold it in place.
- b) Fit the flat wrench around the hex nut-like adapter part of the counterweight.
- c) Hold the counterweight nut with the flat wrench (see left hand in diagram), and thread the attachment clockwise. into the counterweight nut (see right hand).
- d) Do not over-tighten but use a firm grip for a hand tightening. Repeat the installation procedure for the other side.

5) Detailing Polishes and Products Selection – CTI Pro Paint Care™ Line and Other Leading Professional Products

Cyclo products are specifically formulated for the speed, action, and weight of the Cyclo Polisher. While many other professional grade machine-application polishes are also proven to give satisfactory results, the company's recommendation for superior results are the field-proven Genuine Cyclo CTI products and Genuine Cyclo Accessories. For additional information on use and application of other leading professional quality polishes and products, please visit our website's support section at www.cyclotoolmakers.com.

Selection of the appropriate detailing chemical is essential for proper results. Many polishes can remove light scratches, and there are products specifically designed to remove swirl-marks and holograms. There are more aggressive products and it is important to understand the difference between a polish, wax and sealant. When using these products, read all instructions carefully and we recommend that you always use the least aggressive product and pad combination necessary for your finish condition.



- a) **CTI Pro Paint Care Heavy Compounding Gel** – Removes scratches, heavy oxidation, orange peel, acid rain damage and other defects. Very aggressive cutting and compounding polish for use on any surface.
 - b) **CTI Pro Paint Care Light Compounding Liquid** – Eliminates hairline scratches and oxidation. Leaves a smooth surface ready for polishing. Follow with our Polish & Swirl Remover (CTI 1 Pass Express™), then our Protective Sealant (Pro Paint Care Polish and Protective Sealant).
 - c) **CTI Pro Paint Care Polish and Swirl Remover** – Remove swirls, holograms, and other minor defects while adding depth and gloss. The perfect follow-up to our Light Compounding Liquid. Designed for use on all painted surfaces.
 - d) **CTI Pro Paint Care CTI 1 Pass Express™** – Safely removes swirls, haze, light scratches, mild oxidation and surface contaminants while restoring depth and brilliance. Use in a one-pass application for express polish and seal. Follow with CTI Protective Sealant or CTI Finishing Wax to lock-in the new car shine. Excellent on all painted surfaces, gel coats and clear coats.
 - e) **CTI Pro Paint Care Polish and Protective Sealant** – Our Polish and Protective Sealant is a highly protective sealant that will give your surface up to 6 months of durable protection and brilliant gloss. Shows your paint's original new car shine. Use on all painted and gel coat surfaces.
 - f) **CTI Pro Paint Care Finishing Wax**: This easy to apply cream wax will give your surface excellent UV protection and incredible brilliant gloss. Shows your paint's original new car shine. Use on all painted surfaces.
- 6) **Metal Polishes and Sealants – CTI Metal Polishes and Sealants Line and Other Leading Professional Products**
- Cyclo products are specifically formulated for use with the Cyclo Polisher and though some machine application type polishes may give satisfactory results, we recommend that for the BEST results only the laboratory and field tested Genuine Cyclo Accessories and products be used with the Cyclo Polisher. For additional information on use and application of other leading professional quality polishes and products, please visit our website's support section, www.cyclotoolmakers.com.

- a) **CTI Metal Polish Free Flite™ Cleaner-Polish** – With one easy step this aggressive rubbing compound removes corrosion, oxidation and surface film while also leaving a polished finish that is absolutely stunning. For quality that meets high government standards for its aircraft, insist on Free Flite Cleaner-Polish for your stainless steel, aluminum, billet parts, chrome and virtually every metal that needs polishing.
- b) **CTI Metal Polish Free Flite™ Protective Sealant** – Specially formulated to bond to bare metal, allowing you to deoxidize the surface and effortlessly remove finishing scratches. Plus, its protective coat helps prevent further oxidation. Great for chrome. Use after Free-Flite Cleaner-Polish to seal and lengthen protection interval.



GUIDE TO GENUINE CYCLO ACCESSORIES

The following information will assist you in selecting the appropriate accessory for use with the Cyclo Polisher. For additional tips and application guides, please refer to the application chart included on the back cover of this manual.

1) Pad Selection Guide – Genuine Cyclo Pads

- a) **Detailing pads** – are composed of either high tech foams or wool and synthetic fiber blends. These pads can be used for restoration and defect removal, polishing, applying waxes and sealants as well as final buffing. Each pad type serves a specific function in the detailing process. You will want to match the appropriate pad with the type of detailing liquid compound, polish, wax or sealant.
- b) **Foam pads** – are made from specially designed synthetic polymer foams with small, uniformly shaped cells that may be either open or closed. The smaller cells in open-cell foams are less aggressive in their polishing characteristics. As the cell size increases so does the pads ability to carry detailing liquids and therefore the its level of aggressiveness. Closed cell and stiffer foams work well in polishing harder paints or for more assertive compounding. Open cell foams can wick the lighter liquid elements from polishing liquids, altering their characteristics.
- c) **Wool pads** – are made from a variety of natural wools and synthetic fibers. The yarn blend may also be twisted or not, and the fiber may be treated to have more or fewer barbs. For an aggressive action, our non-twisted 50:50 poly/wool pad is best. Twisted wool can transport more compound, and that increases aggressive when used with an aggressive compound. For final finishing or non-aggressive polishing, our blue and yellow wool blend pads utilize a greater portion of soft synthetics like rayon.

Pad Type	Bonnets	Velcro	DoublePrecision™
White Foam Finishing Pad	71-110	72-110	77-110
Blue Foam Polishing Pad	71-115	72-115	77-115
Green Foam Polishing Pad	71-120	72-120	77-120
Yellow Foam Cutting Pad	71-135	72-135	77-135
Orange Foam Polishing & Compounding Pad	71-145	72-145	77-145
Yellow Cutting/Orange Polishing & Comp. Combo Foam Pad	N/A	N/A	77-135/145
Yellow Foam Scrubbing Pad	71-160	72-160	77-160
The Original Cyclo Cutting White Wool Pad	71-455	72-455	N/A
Yellow Medium Cutting Wool Pad	N/A	72-435	77-435
Blue Polishing Wool Pad	N/A	72-415	77-415

The numbering system for each family of Genuine Cyclo accessories indicates relative aggressiveness, considering all physical characteristics of the materials. Note the last two digits in all cases. In our part numbering system, a 72-145 foam pad is more aggressive than our 72-120 foam pad. A 77-435 is more aggressive than a 77-415 wool pad. The hundreds digit (i.e. the "4" in 77-415 or the "1" in 72-145) indicates material, such as foam, or wool. The relative aggressiveness digits (last 2) do not compare across different materials. That is, one cannot make an inference comparing a -415 (wool accessory) to a -145, -120, -110 or other 100 series (foam) accessory.

d) Scrubbing/Bug& Tar Removal

- Yellow Cutting Foam Pad
 - i. Open cell, premium quality – Foam Bonnet (71-160), Velcro Pad (72-160), DoublePrecision (n/a)
 - ii. Recommended applications: Bug Removal • Paint Deox • Paint Compound • Paint Scratch Removal • Metal Polish/Cleaner
 - iii. Scrubs away hard to remove materials such as bugs, tar, and sap. Also used as a more aggressive deoxidizer.



e) Cutting/Compounding/Deoxidation/Swirl Removal

- Original Cyclo Cutting Wool – Foam Bonnet (71-455), Velcro Pad (72-455), DoublePrecision (n/a)
 - i. Natural wool and polyester blend
 - ii. Recommended applications: Metal Polish/Cleaner • Paint Deox • Paint Compound • Paint Swirl Removal
 - iii. The preferred multipurpose wool/poly pad, used for metal polishing and aggressive paint compounding. This pad is excellent for removing swirl marks and scratches.
- Orange Compounding & Polishing Pad – Foam Bonnet (71-145), Velcro Pad (72-145), DoublePrecision (77-145)
 - i. Closed cell, premium quality
 - ii. Recommended applications: Paint Polish/Cleaner • Paint Deox • Paint Compound • Metal/Chrome Polish
 - iii. An exceptional, all-in-one cleaning and polishing pad. This high density pad has the power to remove light scratches and polish the surface.
- Yellow Cutting Foam Pad – Foam Bonnet (71-135), Velcro Pad (72-135), DoublePrecision (77-135)
 - i. Closed cell, premium quality
 - ii. Recommended applications: Paint Polish/Cleaner • Paint Deox • Paint Compound • Paint Scratch Remover
 - iii. A firm, versatile pad that can be used on everything from compounding and scratch removal to applying paint cleaners and polishes.
- Yellow Cutting Wool Pad – Foam Bonnet (n/a), Velcro Pad (72-435), DoublePrecision (77-435)
 - i. 50% wool, 50% acrylic
 - ii. Recommended applications: Paint Polish/Cleaner • Paint Deox • Paint Compound • Metal/Chrome Polish
 - iii. An exceptional, all-in-one cleaning and polishing pad. This pad has the power to remove light scratches and polish the surface.



f) Cleaning/Polishing/Deoxidation

- Green Polishing Foam Pad – Foam Bonnet (71-120), Velcro Pad (72-120), DoublePrecision (77-120)
 - i. Open cell, 60 pores per inch
 - ii. Recommended applications: Sealant • Paint Polish • Paint Cleaner • Metal Sealant
 - iii. A more aggressive pad than our white or blue pads. The pore density makes it perfect for polishing and removing light oxidation for a stunning shine.
- Blue Polishing Foam Pad – Foam Bonnet (n/a), Velcro Pad (72-115), DoublePrecision (77-115)
 - i. Open cell, 80 pores per inch
 - ii. Recommended applications: Paint/Metal Sealant • Paint Polish • Paint Cleaner • Final Wax Buff • Wax Application
 - iii. The perfect pad for light polishing on any surface. Use with wax and polish for a fine gloss finish or to remove swirl marks.
- Blue Polishing Wool Pad – Foam Bonnet (n/a), Velcro Pad (72-415), DoublePrecision (77-415)
 - i. 70% acrylic, 30% wool
 - ii. Recommended applications: Paint Polishing • Paint Cleaner • Finishing Touch
 - iii. Used for applying the finishing touches on most automobiles. A blend of 70% acrylic and 30% wool, this wool pad is perfect for creating a fine luster on nearly any finish.



g) Wax/Sealant Application

- White Finishing Foam Pad – Foam Bonnet (71-110), Velcro Pad (72-110), DoublePrecision (77-110)
 - i. Open Cell, 100 pores per inch
 - ii. Recommended applications: Extreme Shine • Final Wax Buff • Wax Application • Sealant • Metal Sealant
 - iii. This superfine pad is used in final buffing, after polishing with other pads.



h) Final Wax Buff

- White Finishing Foam Pad – Foam Bonnet (71-110), Velcro Pad (72-110), DoublePrecision (77-110)
- Microfiber Suede Pad Cover
 - i. Ultra soft microfibre
 - ii. Recommended applications: Extreme Shine
 - iii. An ultra-soft cover used for final touches. Removes all surface residue.



2) Genuine Cyclo Scrub Brush Selection Guide

Your Cyclo polisher is also a scrubber. Fitted with Genuine Cyclo brushes, its action mimics the motion of hand-scrubbing. By simply attaching two Cyclo Brushes to the heads you can clean carpet, upholstery, boat decks, tile, grout and more. The orbiting motion of the Cyclo machine brushes combined with the brushes' high quality bristling safely cleans leather, fabric, upholstery and carpets. **Each brush kneads and scrubs vibrates loose any soil or debris. The brushes do not spin, an action that could damage fabrics and carpet.** Brushes are available in four varieties, and each brush is made of durable nylon bristles modified for specific applications. Use your favorite carpet or upholstery shampoo with the Cyclo brush to remove tough stains from your vehicle, RV or your home.

a) Upholstery, Fine Carpets, Fine Interiors

- Gray Ultra Soft Upholstery Brush – 76-810
 - i. Flexible bristles, flagged (split) for softness and water-carrying capacity.
 - ii. Recommended applications: Ideal for use on headliners, leather, and other fragile upholstery
 - iii. Natural fiber fine carpets

b) Fine Carpets, Durable Carpets, Auto & RV Carpets & Upholstery

- Aqua Soft Carpet Brush – 76-830
 - i. Recommended applications: Perfect for most carpets

c) Auto & RV Carpets & Interiors, Tile & Grout, Durable Carpets

- White Standard Carpet Brush – 76-840
 - i. Recommended applications: The white brush is designed for more vigorous cleaning of floor mats; more durable carpets

d) Tile & Grout, Truck Bed Liners, Heavy Scrubbing

- Black Scrub Brush – 76-870
 - i. Recommended applications: cleaning tile and stone floors, pick-up truck bed liners



3) Genuine Cyclo Pad Covers

Each pad cover has a specific function in the detailing process. Whether you are applying polish, cleaning interior surfaces, buffing wax, or adding that final touch to bring paint and interiors to a gorgeous shine. The pad covers fit snugly over foam pads with a durable elastic cuff. They will not fly off, bunch, or tear as you buff your paint. For additional tips and application guides, please refer to the application chart included with this manual.

Type Product Number

Microfiber Suede Pad Cover	73-515
Microfiber Terry Pad Cover	73-530
Cotton Terry Pad Cover	73-550

a) Extreme Shine

- Microfiber Suede Pad Cover – 73-515
 - i. Recommended applications
 - ii. Ultra-soft and ideal for removing surface residue
 - iii. Buff out for extreme shine

b) Final Wax Buff

- Microfiber Terry Pad Cover – 73-530
 - i. Recommended applications
 - ii. The preferred cover for applying polish and buffing wax
 - iii. Its hooked fibers remove surface residue.

c) Upholstery

- Cotton Terry Pad Cover – 73-550
 - i. Recommended applications
 - ii. Perfect for cleaning interior surfaces and for buffing, polishing
 - iii. Drying exterior surfaces



4) Genuine Cyclo Discs

Genuine Cyclo ProShine (cushioned abrasive "Micro-Mesh") discs and Fast Discs (non-woven scrubbing discs similar to a soft Scotch-Brite) are handy for scratch removal and floor and board cleaning. ProShine Discs require a 72-920 ProShine™ Interface Pad that fits between a Velcro attachment system (Rubber Pad Holders or ProGuard Orbital Backing Plates; alternately, to use on a machine with DoublePrecision attachment system the ProShine Discs require a 77-920 Interface Pad.

Type

Product Numbers

ProShine Abrasive Discs in grades of 1500, 2400, 4000, 6000, 8000, 12000

72-701, 72-702, 72-704, 72-706, 72-708 & 72-712

Fastcut 600 Grit Disc

74-660

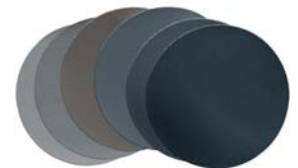

a) Deep Scratch Removal

- ProShine Discs 1500-4000 (72-701 - 72-704)
 - i. Recommended applications:
 - ii. Discs are ideal for removing scratches and use water as a lubricant for discs. Start with 1500 or 2400 and you should be able to switch over to light compounding liquids after 4000.

b) Light Scratch Removal

- ProShine Discs 2400-12000 (72-702 – 72-712)
 - i. Recommended applications: Discs are ideal for removing light paint or plexiglass scratches. Use soapy water or detailing spray as a lubricant for discs. Start with 2400 or 4000 grade disc on one head of the polisher and just use a Green Foam Polishing Pad or Blue Foam Light Polishing Pad on the opposite head to minimize amount of sanding area and impact.
 - ii. Once sanded, you should be able to switch over to light compounding, swirl remover or polish after application of 6000 or higher grade or discs.

c) Aggressive Surface Scrubbing and Cleaning

- Fastcut 600 Grit Disc (74-660)
 - i. Recommended applications: Requires interface pad such as 77-920 or 72-920.
 - ii. Use Fastcut discs for scrubbing floors, tile, showers, hockey arena boards (puck marks); excellent for removing bugs from wing leading edges, auto bumpers and more.



MACHINE OPERATING INSTRUCTIONS

Your Cyclo Polisher has two heads rather than the single head common on other orbital-motion tools. As soon as the Cyclo Polisher is placed on a working surface and powered on, orbital "hand-rubbing" action takes place. Each sides reactive forces from its polishing or scrubbing is counteracted by the opposite side. Therein lies the secret of the tool's ability to do many different types of jobs that could not be done with a single head orbital or a rotary tool. The two heads move in a circular motion without forced spinning and are timed and weighted to balance away vibration forces. All the energy from the motor is directed to the polishing or scrubbing action, and none returned to vibrating the user.

IMPORTANT POLISHER OPERATION INFORMATION –EXCESSIVE PRESSURE DOES NOT IMPROVE PERFORMANCE AND MAY DAMAGE THE POLISHER'S TRANSMISSION. The hand-action of the polisher's heads prevents surface damage regardless of the pressure applied. Move the machine slowly. You need not be afraid of burning, gouging, or swirling the surface.

1) General Polishing Instructions

- After you have placed the pads or bonnets on your Cyclo Polisher, connect the tool to the power supply.
- Apply a small amount (about a teaspoon, or a spot the size of a dime) of the proper polish or compound to each pad.
- Place the Cyclo Polisher, pad side down on the surface, move the tool around before turning it on in order to distribute the polish within the pad over the surface.
- Turn on the tool and move it back and forth and side to side in a latticed pattern across an area approximately 2' x 2' in size. Use the first 20-30 seconds to further evenly spread the liquid detailing product. Then slow down.
- Grip both handles of the polisher, and using only light or moderate pressure - letting the action and the weight of the tool do the work - move the polishing heads across the area at a very slow comfortable speed. Deoxidize or polish the entire car in this manner. When you have finished, you can remove any powdery or lubricant residue left by your liquid products using a microfiber towel. You may also use white foam pads or bonnets, or microfibre or terry pad covers to removing any remaining residue.
- If the residue does not wipe off easily, the surface is still not clean, repeat steps 2-5 as necessary.
- As the pads become fully impregnated with polish or oxidized paint, they should be removed and washed. Never keep polish in pads overnight. Additional pad care information is included below.

- 2) **Pad Care Instructions.** **IMPORTANT INFORMATION** Clean pads are important to perfect polishing. Cleaning your pads well and before they dry will extend their life. Use Genuine Cyclo CTI Pad Care – Pad Cleaner (84-404, 84-406) or a mild detergent and warm water. **DO NOT WASH PADS IN GASOLINE OR SOLVENTS.** For maximum life, be sure to clean pads, bonnets, and pad covers after each use. To clean, spray CTI Pad Cleaner on the pad face, work in, and let soak in a container of water-diluted Pad Cleaner. After soaking, rinse out, and if clean, place the items back on the Cyclo Polisher and run for a few seconds. Allow the action of the machine to shake excess water from the pad. You may also just squeeze dry (do not twist or wring). Then allow to air dry. The pads and bonnets should be cleaned as soon as possible after use, and do not allow compounds to dry in pads. The wool fiber pads should also be washed with CTI Pad Cleaner and then run through with a brush. Pads and other accessories can also be machine washed in warm water and tumble dried in a clothes dryer.

3) General Scrubbing Instructions

- Begin by vacuuming the loose debris and materials from the area to be scrubbed.
- Pre-treat the area with Cyclo CTI Pad Care – Pad Cleaner or an alternative carpet cleaning agent or enzyme
- With scrub brushes installed on the Cyclo machine, connect the tool to the power supply. For additional information on the installation of scrub brushes, please refer to the CYCLO POLISHER SET-UP section of this document.
- Place the Cyclo machine, brush side down on the surface.
- Turn on the tool and move it back and forth and side to side in a latticed pattern.
- Grip both handles of the polisher, and using only light or moderate pressure - letting the action and the weight of the tool do the work - move the polishing brushes across the area at a comfortable speed.
- When you have finished, you can wipe down the treated areas with an absorbent towel. If you have an extractor or wet vacuum, lightly wet the area and extract the water.
- As the brushes become impregnated with loose fibers, they should be removed, combed out and cleaned.

4) General Pad Cover Instructions

- Disconnect from power source. Lay the polisher with heads facing up on your lap, a bench or flat surface. You can use the insert removed from inside the polisher box to support polisher and hold it in place.
- Attach pads or bonnets onto the Cyclo Polisher. It is common to use the Green Polishing, Yellow Cutting or Orange Compounding and Polishing Foam Pads or a wool pad.
- Stretch the pad cover's elastic ring over the foam. Make sure that you have completely covered the foam pad. The elastic band should be place so as not come in contact with each other when running. The Pad Cover will completely cover the foam (or wool) pad.
- Rotate each head to ensure that the Pad Covers do not contact each other. If the Pad Covers contact each other continue to smooth out the covers over the pads to remove any wrinkles in the material and to ensure that elastic bands are not making contact.
- Connect the tool to the power supply.
- For use in final buff and exterior detailing, follow the General Polishing Instructions above.
- For use on interiors and upholstery, please refer to the General Scrubbing Instructions above

ADDITIONAL TIPS AND INSIGHTS:

1) Attaching Rubber Pad Holders and Bonnets to Head Assemblies:

- Disconnect from power source. Lay the polisher with heads facing up on your lap, a bench or flat surface.
- Take pad holder or bonnet and turn it completely inside-out.
- Center the inside-out pad holder or bonnet onto the head assembly.
- Flip one edge of pad holder or bonnet over the head assembly using your thumbs to stretch it over the head.
- Rotate pad and stretch the other half of the pad holder or bonnet over the head assembly.
- Use your thumbs to center the pad holder or bonnet over the head for an even fit.
- Complete for both head assemblies.

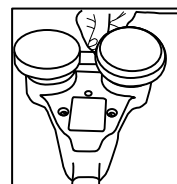
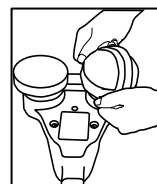
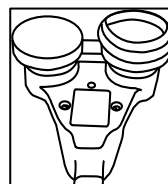
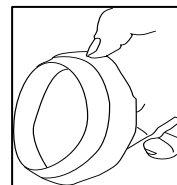
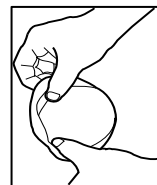
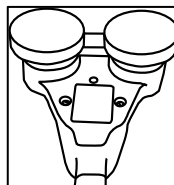

USER MAINTENANCE AND TROUBLESHOOTING

Below are instructions on care and maintenance of your polisher. You can also visit our website at www.cyclotoolmakers.com for tutorials and video instructions on proper tool care and maintenance.

HOW TO MAINTAIN YOUR CYCLO POLISHER

- 1) **Be certain the air supply is filtered and lubricated.** Check for leaks and repair as necessary.
- 2) **Clean your tool of dirt, fiber, and other debris by blowing it out with compressed air.**
 - a) *If tool should get wet, be sure to blow dry the underside of the tool.*
- 3) **If the previous steps have not enabled you to determine the problem, please return your polisher to Cyclo Toolmakers or your dealer for a complete diagnosis. Follow the return instructions below!**

Compressed Air

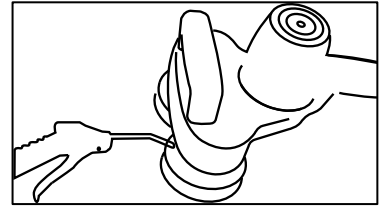

ANY OTHER SERVICING SHOULD BE PERFORMED BY THE FACTORY OR AN AUTHORIZED CYCLO SERVICE CENTER.

ADDITIONAL MAINTENANCE AND SERVICE INFORMATION

LUBRICATION:

This tool was properly lubricated at the factory and is ready to use. The gears should be inspected after approximately 400 hours of use. If necessary, re-lubricate with Texaco Multifax #2 or equivalent.

TIMING:

The secret of the operation of your Cyclo Polisher lies in the fact that the two heads are timed exactly 180 degrees apart. This is necessary for the balanced operation of the tool. If the machine is disassembled, use the following procedures to insure proper timing of the heads.

- a) **DISSASSEMBLY AND REASSEMBLY OF PNEUMATIC MODEL 12A TOOL IS MUCH MORE COMPLEX THAN WITH CYCLO ELECTRIC TOOL MODELS. PERFORM AT YOUR OWN RISK.**
- b) Turn the tools main case upside down, with the motor case, cover plate, and idler gear removed. Move the two heads together as close as possible. Then, put a heavy rubber band around the side of the two heads to keep them together.
- c) Turn the tool right side up and carefully replace the idler gear without moving the drive gears. Now, pack the recessed well in back of the idler gear with lubricant. Also, lubricate the metal shafts in the center of each gear.
- d) The case is sealed with clear silicone between cover plate and main gear case. Motor position in motor cap is critical.
- e) Reassemble the cover plate and motor case and remove the rubber band.

BEARINGS:

The bearings in the counterweights will loosen slightly with continued long use. This actually improves the action of the tool by allowing the heads to tilt slightly and follow a contoured surface better. These bearings should not be considered defective until they become objectionably noisy at which time the entire polisher should be sent to an authorized Cyclo service center for repair.

HEADS:

The head assemblies (0.75" thick black neoprene discs) and ProGuard Orbital Backing Plates of the polisher will wear out gradually with use. The head assemblies (60-055) should be replaced when they no longer hold the rubber pad holder or polishing bonnets firmly in position. Simply turn the polisher upside down (so the twin heads are facing up), and rest the polisher on a counter or on your lap. Slide the 5/8" flat wrench between the head and the counterweight. With the wrench in one hand and the head in the other, twist the head counterclockwise until the threaded shaft is completely clear of the nut. Oil the nut threads slightly, and reverse the above procedure to attach new heads or other attachment system. Be sure to screw the head of brush straight into the counterweight nut. Do not cross-thread. If the shaft seems to be screwing into the nut with difficulty, back it out and start over again. Be sure to tighten the heads or brushes snugly into the nut.

CYCLO TOOLMAKERS, INC. ONE-YEAR LIMITED WARRANTY

CYCLO TOOLMAKERS, INC. WARRANTS this machine to the original purchaser to be free from material or workmanship defects for a period of ONE-YEAR from the date of purchase (but no longer than two-years from date of manufacture). Our obligations under this warranty are expressly limited to replacement or repair of such parts as we determine to be defective and the labor required for installations. Our obligation is limited to performing repairs in our U.S. factory location (address below). Your Cyclo dealer may provide local services at its own option. If you ship your product to us for repair and your claim for service is covered by this warranty, we will pay the return freight cost to places within the 48 contiguous United States, but not to other locations.

Conditions resulting from misuse, negligence, alterations, accidents, damage caused by improper use of chemicals, repair by unauthorized parties, or "wear and tear" from normal usage, are not covered. Disassembly of the tool may also void this warranty.

This warranty does not cover damage to machine occurring in shipment, nor damage caused by alterations, fire, accidents, force majeure, misuse or abuse.

To invoke coverage under this warranty you, the (end user purchaser), must register within 15 days of purchase and provide proof of purchase (sales receipt) when requesting warranty service.

We recommend that only Genuine Cyclo accessories be used with this machine. Our products are specifically designed, formulated and tested for product capability.

LIMITATION OF WARRANTY AND WARNING

Most failures of pneumatic tools are the result of an unclean air supply or lack of lubrication. Air pressure can cause dirt or water in the air supply to contaminate the motor and its vanes. This contamination may cause the tool to stop operating. Damage caused by air supply that is not clean and properly lubricated will not be covered by Cyclo Toolmaker's limited warranty.

SENDING YOUR CYCLO POLISHER IN FOR REPAIR:

- ☐ Please attach a note answering the following questions:
 - Is your tool under warranty? (Enclose proof of purchase in order to be covered)
 - Would you like an estimate, or a repair?
 - ☐ If you would like your tool immediately repaired, please indicate that Cyclo Toolmakers, Inc. has permission to make repairs costing up to \$100. We can only repair your tool if you have provided us with your credit card information. For all repairs costing over \$100, Cyclo will contact you to confirm the price before making any repairs.
 - What is wrong with your tool? Please include a complete description of the problem, the conditions under which the polisher failed or is operating incorrectly
 - Please also include all your contact information, \$15 for US domestic return shipping address and phone numbers, and your email address so that you can be contacted with a resolution or estimate to repair your polisher. There will be no charge for product failures covered by our warranty.
- ☐ If your tool is not claimed within 30 days after repair quotation (when not in warranty), your tool will be disposed of. If \$15 was included for return shipping, we will return the polisher to the address given.
- ☐ Repair labor is \$55/hour.
- ☐ It can take up to 2 weeks or longer after receipt to provide an estimate or repair.
- ☐ Send repairs to: Cyclo Toolmakers, Inc. ATTN: Service Dept. 1740 Skyway Drive Bldg. C Longmont, CO 80504 U.S.A.

DISPOSAL AND RECYCLING INFORMATION:

USA and other non-EU countries Do not dispose of power tools in the household waste! You may return your used polisher to Cyclo Toolmakers, Inc to be recycled in an environmentally friendly manner.



TECHNICAL SPECIFICATIONS MODEL 12A

	Supply Pressure*	Tool Inlet Pressure	S.C.F.M.	RPM	Sound Pressure
Model 12A:	120 psi	85 psi	22.8	n ₀ = 3260/min	94 db C weighted
	90 psi	70 psi	19.3	n ₀ = 3050/min	91 db C weighted
	70 psi	55 psi	14.0	n ₀ = 2600/min	89 db C weighted
	60 psi	42 psi	10.8	n ₀ = 2200/min	88 db C weighted
Weight:	6.0 lbs (2.7 kg)				
Pad or Bonnet Capacity:	2 x 4" (2 x 100 mm) diameter				
Housing:	Heavy-duty cast aluminum				
Orbital Stroke Length:	5/16 in. (8 mm)				
Hand-Arm Vibration:	1.27 m/sec^2 (uncertainty 0.17 m/sec^2)				
Testing Labs:	Intertek ETL SEMKO for CE EMC and Safety (per EN 60745-1, -2-3) and S&V Solutions for hand-arm vibration (ISO 20643 and EN/ISO 28927)				

* Note- testing utilized a 50' 3/8" air supply hose resulting in a 15-30 psi pressure drop between supply and tool inlet.

THE APPEARANCE OF YOUR CYCLO POLISHER

Each of our Cyclo Polishers are hand crafted with the same superior level of quality and workmanship. As all handmade items will vary slightly, we cannot guarantee that each polisher will be identical with every other one of our polishers. You may notice light sanding or buffing marks in the hand-finished aluminum castings. These are all marks of an authentic Cyclo Toolmakers tool. Naturally, Cyclo Toolmakers, Inc. will replace or repair material or workmanship defects. Refer to the Cyclo Toolmakers Warranty for further information.

JOIN ORBIT CLUB TODAY

Join the Cyclo Toolmakers' Orbit Club and you'll receive preferred customer discounts, special news, usage tips, and exclusive members-only offers. Simply go online and provide us with your email address. Just visit the Cyclo website at www.cyclotoolmakers.com and click the Orbit Club link to sign up. Then, you'll be the first to receive:

- Performance tips to increase productivity
- News and events to improve your business
- Special offers and product news

We look forward to seeing you there!

CYCLO POLISHER PARTS DIAGRAMS

TBD

CYCLO APPLICATION CHART



Cyclo Genuine Accessory Guide Maximizing the capabilities of your Cyclo Dual Head Orbital Polisher begins with using genuine Cyclo accessories. Choose from a wide range of pads and pad covers for polishing, compounding, cutting, finishing, and scrubbing. Various brush attachments are also available for cleaning carpet and other surfaces as delicate as leather and as rough as stone flooring.

PART NUMBER	CYCLO GENUINE ACCESSORY	COLOR	ATTACHMENT	Extreme Shine	Final Wax Buff	Wax Application	Sealant	Paint Polish	Paint Cleaner	Paint Deox	Paint Compound	Paint Scratch Removal	Plexiglass	Metal Polish/Cleaner	Metal Sealant	Bug Removal	Tile And Grout	Upholstery	Fine Carpets	Durable Carpets	Truck Bed Liners	Ice Hockey Rink
FOAM PADS	110 Series	Finishing Pad This superfine pad returns dull painted surfaces to their original showroom shine. Excellent for applying sealants and removing wax.	White	Bonnet/ Velcro/ DoublePrecision	●	●	●								●							
	115 Series	Light Polishing Pad The perfect pad for light polishing on any surface. Use with wax and polish for a fine gloss finish or to remove swirl marks.	Blue	Bonnet/ Velcro/ DoublePrecision			●	●	●						●							
	120 Series	Polishing Pad A more aggressive pad than the Finishing Pad . The pore density makes it perfect for polishing and for removing light oxidation. Leaves a stunning shine. The most popular Cyclo pad.	Green	Bonnet/ Velcro/ DoublePrecision			●	●	●						●							
	135 Series	Cutting Pad A firm, versatile pad that can be used on everything from compounding and scratch removal to applying paint cleaners and polishes. Features high performance pre-polymer foam with low compressive load deflection.	Yellow	Bonnet/ Velcro/ DoublePrecision				●	●	●	●											
	145 Series	Compounding & Polishing Pad An exceptional, all-in-one, cleaning and polishing pad. This high density pad has the power to remove light scratches and polish the surface. It's the preferred pad among top car manufacturers.	Orange	Bonnet/ Velcro/ DoublePrecision				●	●	●	●	●										
	160 Series	Scrubbing Pad A true workhorse of a pad. Scrubs away hard to remove materials such as bugs, tar, and sap. Can also be used as a more aggressive deoxidizer.	Yellow	Bonnet/ Velcro					●	●	●	●		●		●						
WOOL PADS	455 Series	Original Cyclo Cutting Wool Pad The preferred multipurpose wool/poly pad, used for metal polishing and paint compounding. Excellent for removing swirl marks and light scratches.	Natural	Bonnet/Velcro				●	●	●	●	●		●								
	435 Series	Yellow Medium Cutting Wool A wool/acrylic blend with a moderately aggressive texture that is perfect for reducing significant pits and scratches. Excellent pad for everyday cutting.	Yellow	Velcro/Double Pre.				●	●	●	●	●		●								
	415 Series	Blue Polishing Wool Used for applying the finishing touches on most automobiles. A blend of 70% acrylic and 30% wool, this wool pad is perfect for creating a fine luster on nearly any finish.	Blue	Velcro/Double Pre.				●	●	●	●	●		●								
PAD COVERS	73-515	Microfiber Suede Pad Cover An ultra-soft cover used for final touches. Removes all surface residue.	Varies	Over Pad	●																	
	73-530	Microfiber Terry Pad Cover The preferred cover for applying polish and buffing wax. Its small fibers are hooked, which enables them to grab, hold, and remove surface residue. Will leave your surface with a sparkling shine.	Varies	Over Pad		●																
	73-550	Cotton Terry Pad Cover A 100% cotton terry cover. Perfect for cleaning interior surfaces and for buffing, polishing, and drying exterior surfaces.	Varies	Over Pad		●																
BRUSHES	76-810	Ultra Soft Upholstery Brush (8 mil poly) The brush for delicate surfaces. Each bristle is "flagged", a technique that splits the bristle ends into multiple fine tips. Ideal for use on headliners, leather, or more fragile upholstery and natural fiber fine carpets.	Gray Bristle	Threaded Shaft														●	●			
	76-830	Soft Carpet Brush (10 mil poly) This brush features medium crimped bristles for gentle but thorough cleaning, kneads and vibrates loose any soil or foreign matter. Perfect for most carpets.	Aqua Bristle	Threaded Shaft																●	●	
	76-840	Standard Carpet Brush (12 mil poly) The brush designed for more vigorous cleaning. It is recommended for floor pads and more durable carpets. The Standard Carpet Brush is stiffer and less giving than the Soft Carpet Brush .	White Bristle	Threaded Shaft																	●	
	76-870	Stiff Scrub Brush (18 mil poly) Our most aggressive brush. Provides exceptional scrubbing power on tough surfaces. Used for cleaning tile, stone floors, and pick-up truck bed liners.	Black Bristle	Threaded Shaft																		●
DISCS	72-7xx series	Cyclo ProShine™ Ultrafine cushioned abrasive discs used for removing orange peel and fine scratches from paint and plexiglass. Available in grades of 1500, 2400, 4000, 6000, 8000, and 12,000. Used with ProShine Interface Pad (79-920) and Rubber Pad Holder (79-101) or ProGuard™ Orbital Backing Plate (79-112-5/16). Alternatively, you can use the ProShine DoublePrecision Interface Pad (77-920).	Varies	Velcro								●	●									
	74-660	Fastcut™ 600 Grit Pad This coarse nylon pad is strong, durable, and specifically designed for rough surface areas. Polishes aluminum diamond plate, pitted aluminum, chrome, even glass. Also used to remove puck marks from the walls of ice hockey rinks. Use with Rubber Pad Holder (79-101) or ProGuard™ Orbital Backing Plate (79-112-5/16).	White	Velcro																		●

Copyright © 2005-2011 Cyclo Toolmakers, Inc. All Rights Reserved. CTS1008

Send orders to your Cyclo Toolmakers dealer. If you need information on a dealer in your area, please visit our website at www.cyclotoolmakers.com.

Entire contents ©2005-2011 Cyclo Toolmakers, Inc. All rights reserved. CYCLO, ORBIT CLUB, PROGUARD, VES, FASTCUT, CTI PRO PAINT CARE, CTI 1 PASS EXPRESS, FREE FLITE and Cyclo Toolmakers, Inc logo are registered and unregistered trademarks of Cyclo Toolmakers, Inc. VELCRO is a registered trademark of Velcro USA and its affiliated companies.



LOOK FOR THE SPACE-AGE BODY WITH THE ORBITING HEADS. Polisher configuration, including tapered conical motor housing, dual heads, and t-grip handle, is a registered design trademark of Cyclo Toolmakers, Inc.